

General particulars

Name : Lastdrager 5
 Type of vessel : Flat top pontoon
 Length (o.a.) : 45.04 m
 Length (b.p.p.) : 43.2 m
 Breadth (o.a.) : 9.54 m
 Depth (mould) : 2.25 m
 Construction weight : 185 ton
 Empty draught (at sea) : 0.50 m
 Deadweight (at sea, s.w.l.) : 471
 GRT / NRT : 234/70 R.T.
 Classification : BV +100AN Pontoon
 Remarks : suitable for 2 spuds ϕ 610mm

Please note: This drawing is indicative, please contact us for further details regarding the pontoon and its equipment (bollards, winches, manholes, anchors etc.)

Web Frame (spacing 2400mm)

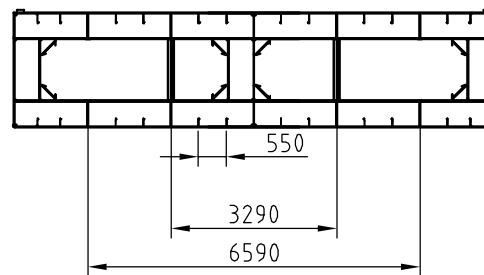

NormalFrame (spacing 600mm)

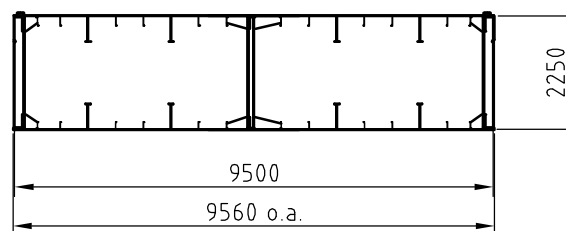

Allowable Load (indic.) ₂	
A	75t
B	40t
C	75t
D	130t
E	130t
F	130t
G	130t
H	130t
I	50t
J	80t
K	130t
L	110t
M	8t/m ²
N	50t

Draught [m] (u.s.k.)	Deadweight [ton]		Ton/cm Saltwater	KMT [m]
	Freshwater	Saltwater		
0.50	4	0	3.90	16.06
0.60	33	38	3.94	13.48
0.80	110	118	4.04	10.37
1.00	190	200	4.14	8.54
1.20	272	284	4.23	7.36
1.40	356	369	4.34	6.57
1.60	441	456	4.38	5.92
1.80	527	545	4.39	5.41
2.00	612	632	4.39	5.04

₂ Allowable Load always with minimum of 0,6x0,6m² loadspreading

REV.	DATE	DRAWN BY	REASON FOR REVISION
02			
01	05-01-2011	W. Kock	Draught table updated
00	09-09-2009	W. Kock	First Issue

PAPER SIZE	SCALE	DRAWING NUMBER	DRAWING STATUS
A3	N.T.S.	VDWLD05-DWG01	PRELIMINARY

CLIENT	PROJECT	DESCRIPTION
Royal Van der Wees Watertransporten B.V.	Fleet drawings	Capacity Plan "Lastdrager 5"

KONINKLIJKE VAN DER WEES WATERTRANSPORTEN B.V.
 's-Gravendeelsedijk 100, Dordrecht
 P.O. Box 629, 3300 AP Dordrecht, Holland
 watertransporten@vanderwees.nl
 Telephone: + 31 (0)78 - 648 26 65 www.vanderwees.nl
 Telefax : + 31 (0)78 - 613 25 96
 Specialists in towage services and transports since 1907

